



# Solara Indoor

## 2026 Owner's Manual

*For Solara 2, 3 & 4 Person Saunas*

*A Way for Everyone to Relax™*



**FOR INDOOR USE ONLY**

**120 V System**

Carbon Infrared Sauna

LTR.2026.1008

REV 2.0





Thank you for purchasing a Cal Sauna, from the industry leader in outdoor resort products. Thoroughly read the instructions and warnings contained in this user manual. Please follow all instructions inside this manual, to have the best experience with your Cal Sauna!



### **READ AND FOLLOW ALL INSTRUCTIONS CAREFULLY**

When using and installing this sauna, always follow the guidelines, regulations, electrical specifications, and general recommendations within this owners manual.



### **Important Safety Information:**

This Sauna is designed to operate on a 120v 25 amp circuit. *(110 volt & 120 volt are interchangeable in this manual)*

Visually inspect all panels and cables before assembly. Inspect for any shipping damages or damage to the heating element, **DO NOT START THE SAUNA IF DAMAGE IS OBSERVED ON THE CABLES OR HEATING ELEMENT.** Contact your dealer or contact Cal Sauna for troubleshooting or replacement parts.

**NOTICE:** This sauna is designed for indoor use only. Please do not expose the sauna to the outdoors, rainfall, or excess moisture, failure to do so can result in injury or lead to the risk of a fire.

**WARNING:** Do not open the power control unit "PCU"/control box, manipulating or disassembling the unit can lead to electric shock or a fire risk. The PCU/control box should only be opened, repaired, or replaced by a certified technician or electrician.



### **Important Safety Information:**

This Cal Sauna sauna is not intended for use by individuals (including children) with reduced movement, chronic health issues, or sensory/physical disabilities. Children must be supervised or accompanied by an adult when sauna is in use.

**Warning!:** Exposure to high temperatures over an extended period of time can lead to dehydration and hyperthermia. Individuals with underlying conditions such as obesity, high cholesterol, diabetes, high blood pressure, heart problems or other chronic health conditions should ask a medical professional to determine a safe heat exposure limit. Healthy individuals should monitor their usage of the sauna, it is recommended to wait about 30 minutes after strenuous exercise before using the sauna.

**Warning!:** Pregnant women should contact a medical professional in regard to using a sauna, exposure to excessive heat for an extended period of time can cause harm to the fetus.

**EXIT THE SAUNA IMMEDIATELY IF YOU FEEL DIZZY, DROWSY, OR ANY DISCOMFORT.**

**Do not enter the sauna** if under the influence of alcohol, drugs, or prescription medication. Excessive heat under the influence can cause disorientation, drowsiness, dehydration, unconsciousness, or cause a heat stroke.

**Warning!:** This sauna must be placed on a level ground, failure to do so can lead to splintered/bent hinges, compromising the integrity of the walls, damage caused from uneven ground is not covered under warranty.



## Table of Contents

Important information.....	2
What are Infrared “IR” rays?.....	4
Important installation information.....	6
Electrical Circuit Requirements.....	7
Shipping & Packaging Information.....	8
Assembly Instructions.....	9
Digital Controller Legend.....	16
Sauna Start up.....	17
Operating the sauna.....	17
Stereo Audio System.....	18
Center Light RGB.....	18
Bench LEDs & Controller RGB.....	18
Tips and Additional Sauna Safety.....	19
Circuit Reset.....	20
Limited Warranty.....	22

## What Are Infrared Rays

Cal Saunas use lightweight low-profile carbon IR heaters. Traditional saunas with a ceramic heating element, compared to the technology of carbon IR heaters, they deliver uniform, consistent heat inside of your Cal Sauna without heating up ceramic or metal housings to spread heat, making our indoor saunas both safer and easier to maintain than traditional saunas. Carbon IR heaters are often used in electronics such as space heaters and in home heating systems by projecting Infrared light when activated. Using innovative designs and engineering solutions, Cal Sauna delivers a clean, safe, and easy to use experience for every Cal Sauna.

### What is Infrared Light?

Infrared light is invisible to the eye but felt as heat. Just as the sun provides life-sustaining warmth, this sauna recreates those wavelengths to deliver therapeutic benefits.

By utilizing the three segments of the infrared spectrum—near, mid, and far—the light deeply penetrates organic tissue to soothe muscle fatigue and joint pain. Whether used for daily wellness or post-workout recovery, it effectively promotes better circulation and overall health.

### Is Infrared Light Considered Safe?

While the sun emits both UV and infrared light, infrared is the safe, non-damaging alternative that provides warmth without the risk of sunburn or cell damage. Its safety is well-established, evidenced by its use in medical applications like newborn incubators. The true power of infrared lies in its specific wavelengths, which penetrate deep into body tissues. This process effectively relaxes tense muscles and boosts circulation, making it a highly effective yet completely safe tool for post-workout recovery and general health.

### What are Electromagnetic Fields? (EMF)

An electromagnetic field is a force field produced by electrically charged objects. It is one of the fundamental forces of nature. A magnetic field is composed of multiple magnetic charges that work off of one another. Our saunas are built with low magnetic field interference with an average range of 5mG-10mG at around 2 inches from the carbon heaters. A comparison to common items used within the home such as a coffee maker creates between 6-29mG within a 4 inch range. The table below also includes other common items or machinery a normal person may encounter on a frequent basis.

Source	mG up to 4 Inches	mG at 3 Feet
Blender	50-220	0.3 - 3
Clothes Washer	8-200	0.1 - 1.4
Coffee Maker	6-29	0.1
Computer	4-20	2.5
Florescent Lamp	400-4,000	0.1 - 5
Hair Drier	60-20,000	0.1 - 6
Microwave Oven	100-500	1 - 25
Television	5-100	0.1 - 6
Vacuum Cleaner	230-1,300	3 - 40
Airplane	50	null

Source: United States EPA Archive

## EMF Continued

The table in the previous shows examples of different sources of EMF's in a persons common surroundings. Our saunas only generate 5mG-10mG about 2 inches above the carbon heater. Currently there is no consensus on the potential health hazards from exposure to EMF's. Available evidence suggests that low-power, low frequency, electromagnetic radiation commonly associated with household appliances and currents do not constitute any short or long term health hazards.

### Disclaimer

The infrared rays emitted by your sauna helps provide heat therapy to your entire body. Heat therapy is a concept shared across many cultures for thousands of years. These mentioned benefits are for reference only and are not meant to imply that our saunas will cure or treat chronic diseases or directly treat symptoms of chronic health issues. Please consult with a medical professional before using a sauna if you have any underlying health problems. Persons with surgical implants (pins, rods, artificial joints, silicone, etc) may speak with a medical professional before using the sauna, although most users with implants do not encounter issues. Irregular heating can cause slight discomfort around the implant area if the operation was recent.

### But How Do Cal Saunas Work?

Infrared saunas are different from traditional saunas in the methods of generating heat. Traditionally saunas used hot steam or heat from hot ashes/coins to heat the sauna chamber, slowly bringing it up to temperature. Cal Sauna uses a industry leading carbon heaters to radiate heat energy over the entire chamber to provide faster heat up times, and efficient operation.

The sauna reaches ideal temperature around 30-45min after activation, with an ambient temp of 60F or higher

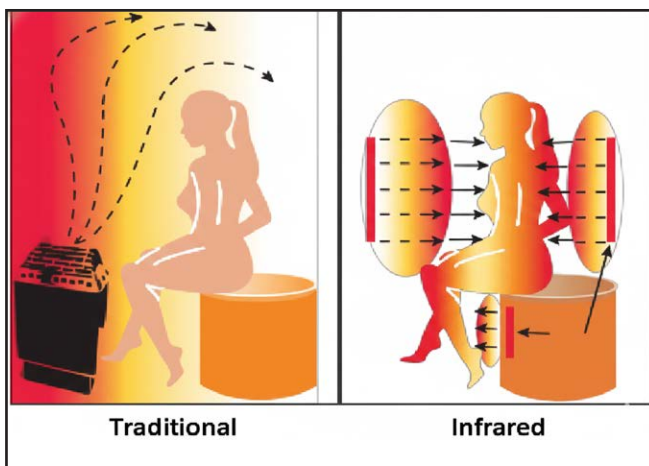

Infrared light heats the body through the process called conversion, creating a deep heating effect to help soothe muscles and joints, similar to how rubbing or massaging a muscle after an intense work out works, you are introducing heat to help recover. Our bodies react by sweating, and naturally sweat often contains collected waste/oils, excess sodium, toxins and even heavy metals. Saunas have been used for hundreds of years to not only promote muscle recovery, but to help remove waste from body, and cleanse a persons skin as well.

When we sweat due to excess heat the body opens up the pores to help release more sweat to keep us cool. In the process oils and contaminants in our pores are expelled from that sweat. The IR heat within the sauna also helps promote blood circulation to bring out the color and glow of your skin.

### Reported Health Benefits Include But Are Not Limited To

- \*Arthritis Pain Relief
- \*Increased Blood Circulation
- \*Cardiovascular Conditioning
- \*Relax injured muscles
- \*Clears Pores
- \*Help Reduce Stress
- \*Reduces Cellulite
- \*Enhances Skin Tone
- \*Removes Excess Toxins

## Important Installation Information



### READ AND FOLLOW ALL INSTRUCTIONS CAREFULLY

This sauna must be installed onto a 25 amp independent 110 volt circuit. Never install, modify, or repair the sauna with the power on.

**This sauna is for indoor use only, designed for personal recreational use. Cal Sauna saunas are not intended, nor designed for commercial use. Malfunctions/Damage incurred from commercial or improper use is not covered under warranty.**

**Electrical Specifications: This sauna is designed to operate on an independent 120 Volt 25 amp circuit. DO NOT CONNECT THIS SAUNA TO A SHARED OUTLET with other electronics. It is recommended to hire an electrician/contractor, if a new circuit must be built for the sauna.**

Do not open the PCU/Electrical box, only a technician should open/replace this component, improper installation or manipulation can cause an electrical fire, and void your warranty.



**Caution:** Do not assemble this sauna if it is not in its intended resting place. Moving the sauna after it is built can cause fractures on freshly screwed panels and damage to the locking hinges.



**Caution:** Visually inspect all panels and cables before assembly. Inspect for any shipping damages or damage to the heating element, DO NOT START THE SAUNA IF DAMAGE IS OBSERVED ON THE CABLES OR ANY HEATING ELEMENT (Carbon Heater or Ceramic).

**Contact your dealer or contact Cal Sauna for troubleshooting or replacement parts.**



**Caution:** Minimum two persons are needed to build this unit safely. DO NOT ASSEMBLE ALONE/ WITHOUT ASSISTANCE.



**Caution:** This sauna must be placed on a level ground, failure to do so can lead to splintered/bent hinges, compromising the integrity of the walls, damage caused from uneven ground is not covered under warranty.



**Caution:** After every use wipe down the interior of the sauna, with a damp cloth towel the wooden panels of this sauna are made of untreated softwood, in particular softwood works great to insulate your sauna due to its unique density, but it will easily absorb water and moisture from its surroundings.



**Caution:** Keep the base and exterior of the sauna dry, away from sources of moisture. The pooling of water from rain or other water sources, without a proper way for liquids to evaporate or drain away from the base, will cause warping on the base over time, voiding the saunas warranty.



**Caution:** The sauna is designed to be indoors only. Acts of God such as damage occurring from a falling tree, or damages from natural disasters such as Hurricanes, Earthquakes, Floods, Blizzards, etc are not covered by your limited warranty. Take careful consideration on final placement & safe guards of and for the unit if the sauna owners residence is susceptible to such events.



**Caution:** The limited warranty for your sauna does not cover acts of nature, that can cause damage or cause/contribute to making the unit inoperable. Acts of nature are considered as unavoidable encounters with nature the unit may encounter such as damages caused by rodents, avians, small mammals such as pets, raccoons etc. Damages caused by unauthorized persons or service animals are not covered by your saunas limited warranty.



**Warning:** Never perform any electrical work or attempt to disassemble, modify, or repair the sauna with the unit connected to an electrical source. Contact an electrician or technician to perform electrical testing if testing on a live circuit is required.



**Warning:** Do not stay within this sauna for excessive periods of time. Excessive heat exposure can lead to dehydration, disorientation, heat stroke, muscle spasms or death. Maintain constant hydration with consistent water intake. Talk to a health provider for additional information on heat exposure and how to properly stay hydrated when using a sauna.



**Warning:** Never enter the sauna if under the influence of medications, prescription drugs, alcohol, or any illicit substance. Many common medications, can affect an individuals perception to heat, pain, and general coordination, which can lead to risks such as heat stroke, injury or death.



**Caution:** Never leave the sauna unattended when its activated/heating. Never leave children unattended near the sauna. Infant children, sensitive persons, individuals with heart conditions, or high blood pressure should not use a sauna. Contact a health care provider for additional care and information.

Please read these instructions thoroughly to ensure proper installation. If you encounter any issues with your Cal Sauna, please call your dealer, or call our customer service phone number for parts or additional support.

**1-800-225-7727**

Monday-Friday

8AM-4:30PM PST

Excluding Holidays



## Circuit Requirements

Cal Sauna Model	Required Amps	Voltage	Wiring #
Solara 2	15 Amps	110v-120v	12 AWG
Solara 3	20 Amp	110v-120v	12 AWG
Solara 4	25 Amp	110v-120v	12 AWG

When installing a sauna into your residence, due to the high amperage of heating systems, the sauna will need an independent circuit to operate from. Most homes are designed with room circuit breakers ranging from 15-20 amps. Depending on the model of sauna purchased, the circuits breaker requirements change as well. The table above describes the electrical specifications required to operate the sauna. It is advised to have a contractor or electrician inspect/build the circuit intended for the sauna. Always follow applicable electrical codes when installing a new circuit. Never attempt to modify or install a circuit for the sauna that does not follow the recommended specifications & applicable regulations/codes.

The Solara 4 requires a 25 Amp breaker for a 120v NEMA connection. This kind of connection/breaker combination is not common in North America. An electrician may advise to upgrade or modify the NEMA plug from the sauna, to a 30 amp NEMA L5-30 to connect to a receptacle (outlets) better designed to handle a larger amperage load. In cases like this notify your dealer to keep a record of, and approve this electrical upgrade.

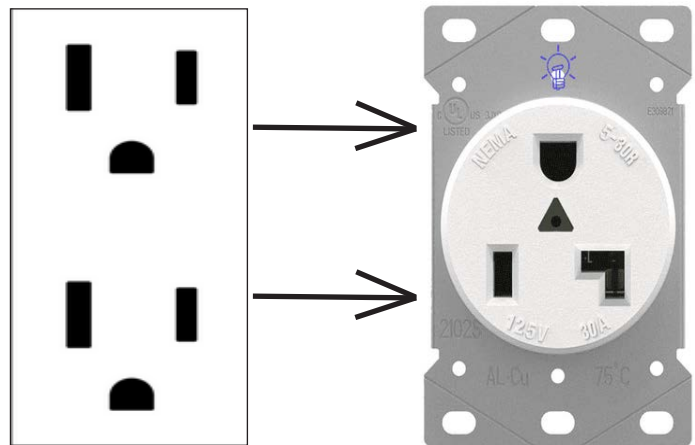

**Note:** Never connect the sauna to an extension cord, only an electrician may modify or change the original NEMA plug from the sauna to a NEMA L5-30, additionally only a contractor or electrician can create/install a new dedicated electrical line for the sauna.

## General Circuit Diagram

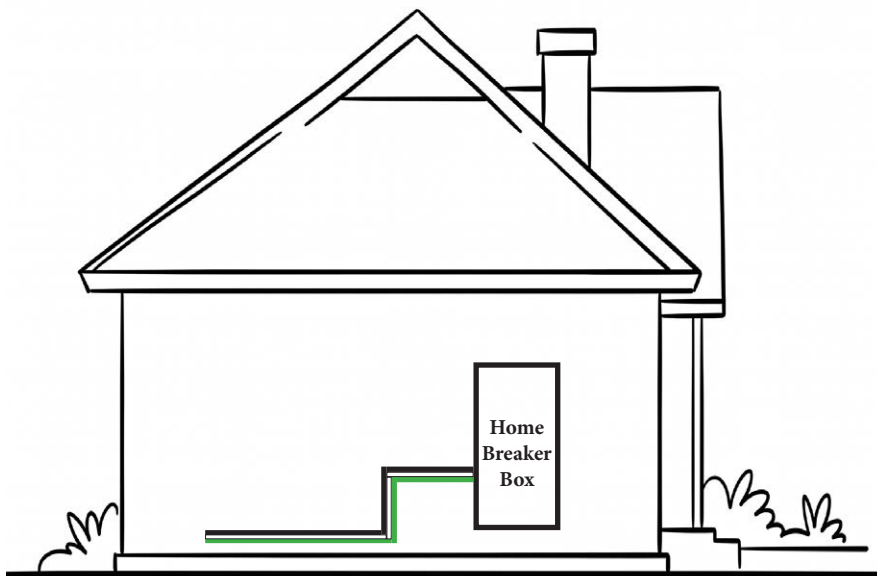
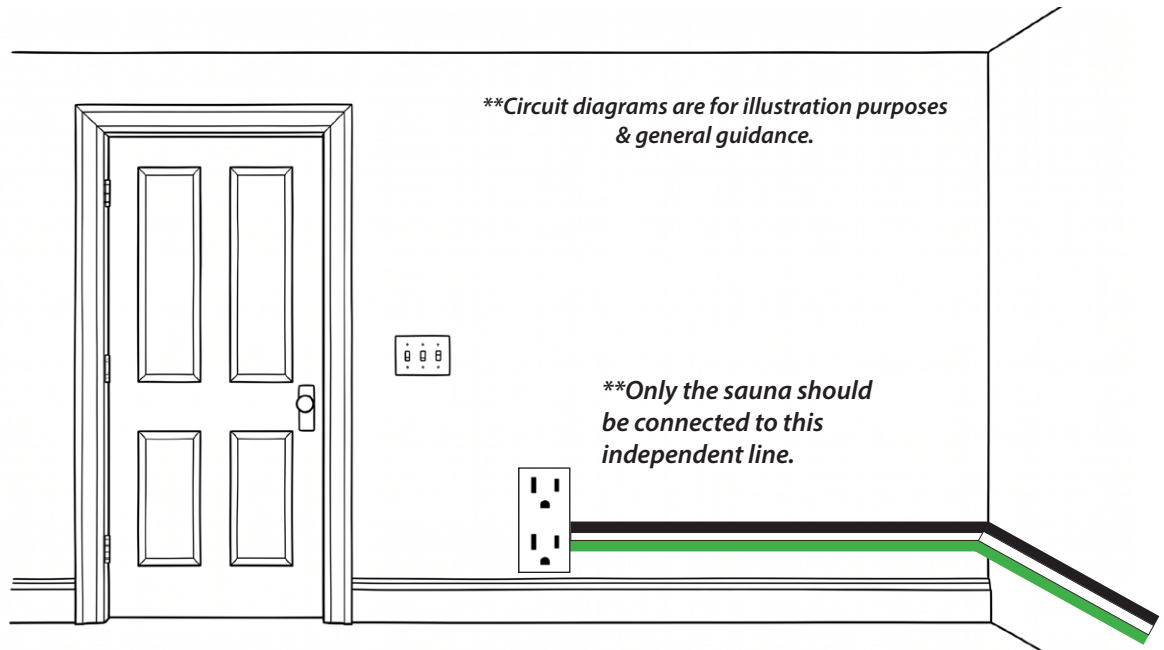

In most cases a new circuit must be built that can handle up to 25 amps, based on the selected sauna mode. A two person sauna requires a 15 amp breaker, a three person sauna requires a 20 amp breaker, the four person requires a 25 amp breaker.

**The circuit must be independent, with no other electronics connected to it.**



**The minimum requirement for the sauna circuits wiring is 12 gauge wire. Do not use wiring that is thinner than 12 gauge**

## Shipping & Packaging Information

Our Cal Saunas are shipped in several separate boxes, depending on the model there can be between 3 - 4 boxes required to assemble your unit. **Do not run a long blade/knife across the front and back face of the packaging to avoid damaging the soft wood of the sauna.**

In the rare circumstance that a sauna panel is missing due to shipping, or a duplicate panel, contact your sauna dealer.

All Cal Saunas heaters are pretested before packaging. A minimum of two people are required to assemble this unit as some of the wall panels weigh up to 40-60Lbs

### Unpacking Care

The sauna is built with soft porous wood, with a layer of laminate on the exterior facing panels. This allows for easier light weight building, while taking advantage of natural insulation properties of the porous wood. **Do not open the packaging of the sauna from the center, only use a short box cutter blade ( Blade < 0.5 inches ) in length, and cut along the edges of the box to open the boxes easily.**

Do not step on top of the sauna boxes. Do not slam the shipping containers onto the floor, as glass components such as the door can come in segments depending on the size sauna you may have ordered.

Prepare a general clearance of at least 10 x 10 feet to properly open and organize/group the panels from the packaging. We strongly advise that a minimum of two people are required to build any size version of our saunas, including their outdoor variant where applicable.

Practice care to avoid stepping on panels not intended to support direct weight such as the wall panels or the glass door to avoid damaging the unit.

### **DO NOT PLUG OTHER APPLIANCES ON THE SAME OUTLET AS YOUR SAUNA**

- This sauna must operate on an independent 25 amp circuit
- This sauna must be installed on level ground
- The sauna can only be placed indoors FOR INDOOR USE ONLY
- Do not spray the exterior nor interior of the sauna with water.
- If the floor is damp install a floor separator/mat to keep the sauna dry.
- Do not store flammable objects near the sauna.

This assembly guide is designed to help assemble all indoor saunas including the two, three, and four person indoor sauna. This guide uses a three person sauna to help illustrate the steps needed to assemble a indoor sauna. Always wear protective gear such as work gloves and work boots when working with wood and heavy materials.

## Placing the Bottom Panel

1



2



**Note:** Prepare a temporary open space of about 8' x 8' around the saunas foundation/ final resting place. This will allow for better clearance when assembling, aligning, and connecting the sauna panels together

1 Center the base of the sauna onto the saunas final resting place ensure that all packaging is removed and that the electrical cord is placed on the center.

3



2 Request assistance from your co-builder to hold the rear panel up against the rear of the floor panel, and obtain the left or right side panel, in this example the right side panel is being used.

3 The sauna panels are designed with buckle clips on their exterior, on the top and the bottom ends of the panels. **Interlock and secure the locks on the side and rear panel.**



Buckle Open



Buckle Fastened

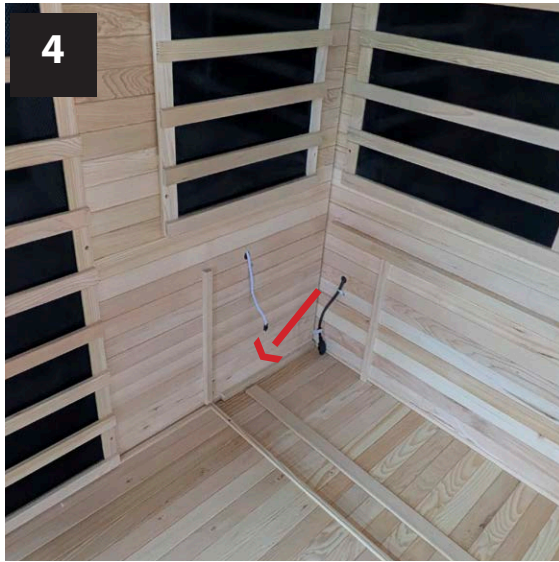

- 4** Once both the rear and side panel are secured, proceed by lining up the floor right up against the two side panels

Proceed with installing the lower bench heater, with the black outlet placed in the bottom corner. There are grooves marked within the side panels and the floor panel that indicate where this lower heater is supposed to rest on.

This lower bench heater panel will be secured into place in step 11.



Behind the bench panel there are a series of connections that must be connected to their intended sockets. **Step 5 refers to the IEC connection, & Step 6** are connections relating to the heating panels within the sauna. After this obtain the bench panel and place it on top of the freshly placed and connected lower bench heating panel **Step 7** connects the LED lights within the bench to the electrical system.

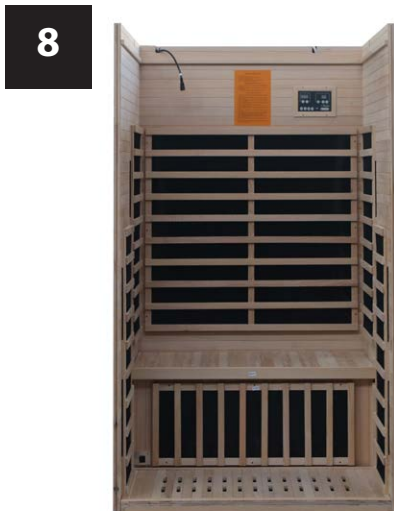

- 8** Now that the bench panel is connected and placed on top of the lower bench heating panel, a secondary person can place, and secure the other side panel with its exterior buckle clips.

This will allow some wiggle room to center the bench seat and prepare it for drilling done in step 11.

**Note:** The IEC socket on the foot area is positioned with ground in the upright position. This is intentional.



- 9** Fasten the bench into place, by using the included wood screws and drilling into the pre-drilled holes on the bench seat. These screws must be placed both in the front, and in the rear of the bench itself.

Install the screws at a slight angle pointing outwards, towards the thicker "Meat" of the wood of panel under it.



- 10** Verify that all exterior buckle clips are secured on all four corners of the sauna.

Obtain the wooden handle for the glass door and using a low torque drill or screwdriver, secure both ends of the handle with its included two screws within its packaging.

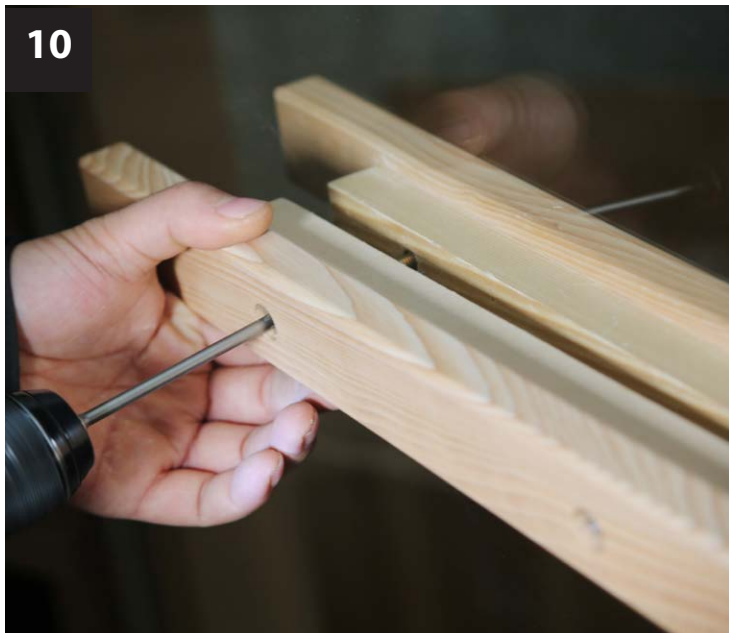

**11**



## 11 Installing the Front panel



**Caution:** The front panel can weigh anywhere between 30-60 lbs due to the density & thickness of the glass panels. A minimum of two able bodied individuals must move, adjust, and secure the front panel to the rest of the sauna.

Have both persons lift the front panel, in a gentle upward motion by the frame itself. Avoid sudden jerking movements as this may unintentionally open the front door from the doors magnetic base, causing a shift in weight that could risk damaging the panel or risking injury of persons assembling the unit. *Once the front panel is leveled, and secured into place, use the exterior buckle clips to secure the front panel to the last two remaining sides.*

- 12** Place the roof of the sauna, the roof rests comfortably within the wooden framing on in the inner top of the sauna.

We advise using a small ladder (less than 6 feet high) in order to accurately slide the roof into place.

12



- 13** Use a drill to secure the roof within the sauna, from the inner roof to the outer wall.

**Do not drill the screws through the exterior of the sauna.**

13



- 14** Return back to inspect the interior of the sauna and re-align the roof if necessary, verify that all exterior buckle clips are still secured as well.

Once the roof is secured you may install the included accessories within your Cal Sauna. Using two of the smaller steel wood screws install the towel rack onto your preferred side panel within the sauna.

14



**15** Install the cup holder accessory into the other side panel with the interior wood screws. You may use a level to make sure the cup holder is installed and properly level.



**16** After installing the accessories use the ladder again to get access to the cords and connections within the sauna. First connect the LED connection to the LED harness from the control box.

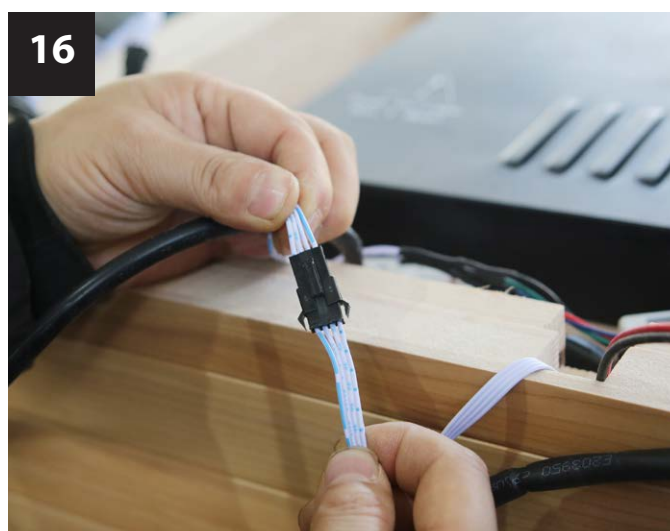

**17** Each of the heating panel electrical cords are cut to a specific length and are also numbered with stickers on each cord.

First connect the black cords closest to the control box to power the rear and side panels.

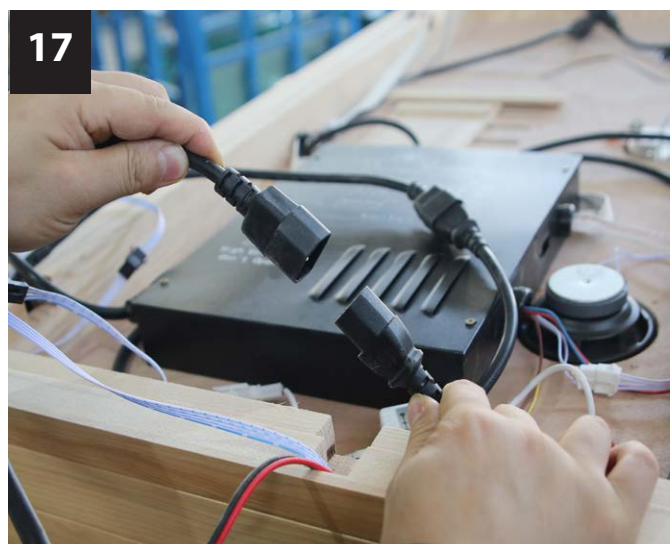

**20** Connect the Stereo system data connections together.

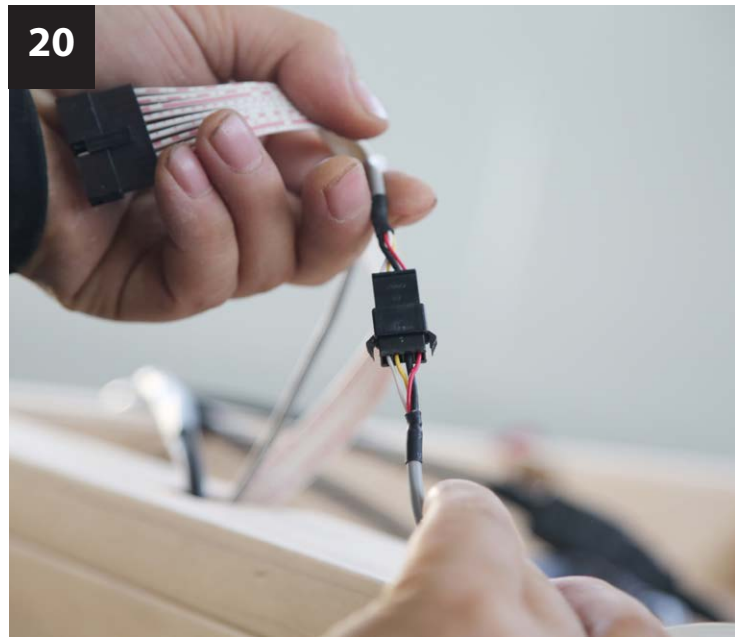

**21** Connect the ribbon connector used for the controller of the sauna. Ensure that the connector clicks into place.

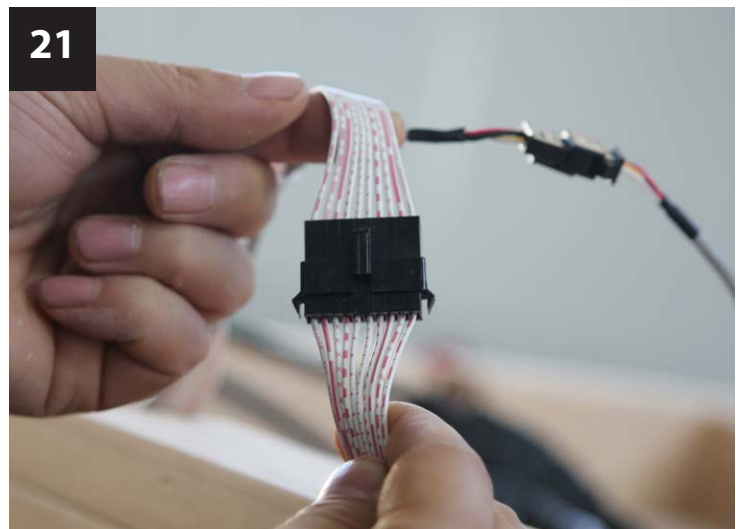

**22** Connect any remaining black cords within the roof of the sauna, to their respective connectors. Move the wires and cords to evenly distribute the cords across the ceiling.



**23** Lastly connect and secure the temperature probe



**24** Obtain the cosmetic top panel and align it with the top of the sauna, securing the top panel with the smaller thinner screw set.

Use a drill to gently drill the cosmetic top panel to the sauna. Its important to install this top panel to avoid dust from entering the control box area and the roof.

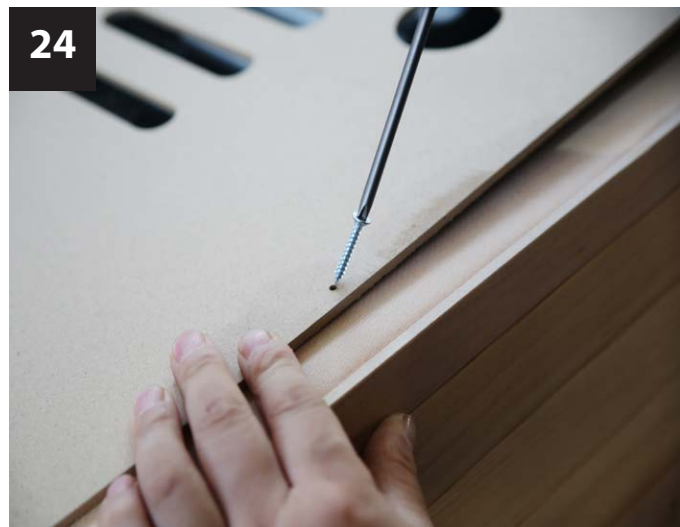

## Digital Control Panel Operation

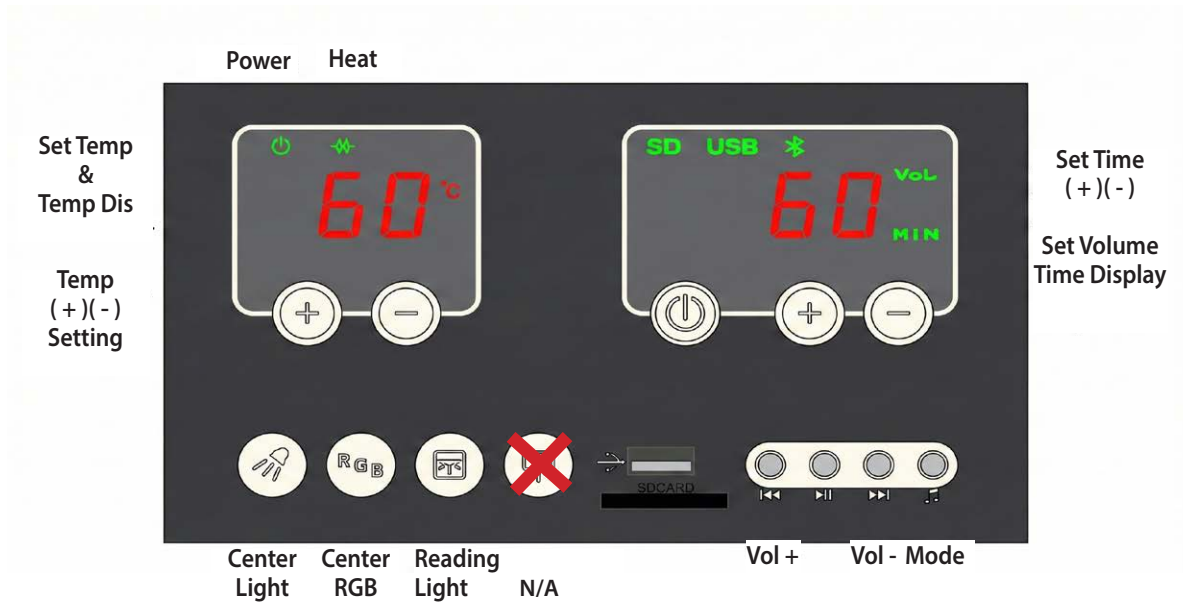

Button & Indicator	Function
Temperature (+/-) Button	Use the "+,-" to raise and lower your preferred temperature. You may hold down the button to raise or lower the temperature setting faster.
Time (+/-) Button	Use the "+,-" buttons to increase the amount of time the sauna has to reach operating temperature. Hold down the buttons to change
"Center" Light Button	Press this to turn on the light inside of your sauna. Press and hold for 3 seconds to turn off.
"RGB" Light Button	The LED reading light inside of your Cal Sauna has RGB abilities, showcase your sauna or set the mood. Press this button repeatedly to cycle through colors.

Stereo Sound System Controls	
Prev	Press to play previous song, long press to increase the volume.
Pause	Press to play or pause your music.
Next	Press to play the next song, long press to decrease the volume.
Mode/Music Icon	Choose between SD Card, USB input, or Bluetooth signal.



The Heat Icon, Indicates when the heater is operating.



The Power Icon, Indicates the sauna has power.

## 1. Sauna Start Up

- 1- Plug the saunas three prong connector to a dedicated outlet, ensure that the circuit is designed to handle up to 20 amps.
- 2- Once connected, enter the sauna and press the “power” button to activate the control panel and heaters.
- 3- Once turned on, set your sauna timer to 60 minutes at 149F, your sauna will now begin to heat up and reach 149F, allow the sauna to pre-heat for up to 30 - 60 minutes.
- 4- After one hour has passed, enter the sauna and select the amount of time you would like the sauna session to last.

## 2. Operating the Sauna

- 1- Setting Sauna Temperature  
Press the “+” or “-” symbols under the temperature display to adjust/set your temperature,
- 2- Setting Operation Time  
Press the “+” or “-” buttons below the temperature display. Once this timer falls to zero an audible beep will occur. You can press the “+” or “-” buttons after the beep to reactivate the sauna.
- 3- The sauna contains an on board memory, it will remember your last set time and temperature for easy restart.
- 4- Remember, the sauna needs to complete a 60 minute warm up cycle to get the sauna up to temperature, once you hear the beep of the timer ending, enter the sauna and press the “+” button to start a new 60 minute cycle to use your sauna.

## 3. Reading Light

Press the “Reading Light” button on the bottom left of the controller to turn on your sauna interior light.

## 4. Switching Between F° and C°

Press the temperature “+” and “-” key together once to switch between F° and C°

## 5. Turning off the Sauna

Press the “Power” button on the sauna controller to turn off the sauna. If you do not intend on using the sauna for a week or more, disconnect the unit.

## Continuous Operation

To extend the lifespan of the saunas carbon heaters, limit continuous operation for up the 3 hours with 30 minutes of non-operation periods in between heating cycles.

## 7. Audio System

- 1 - PREV: Press this to play the previous track, long press to increase the volume from a scale of 0-15.
- 2 - PAUSE: Press to play or pause your music.
- 3 - NEXT: Press this to play the next song, long press to decrease volume from a scale of 0-15.
- 4 - MODE: Switches the source of your music from either an SD card, USB, or Bluetooth. When connecting via Bluetooth, the speakers will appear on your mobile device as "audio". Press the mode button to wake up the system for discovery mode.

**NOTE: This sauna does not support Bluetooth phone calls.**

## 8. Lighting - RGB Control

**The interior center light inside of your sauna has RGB capabilities.**

- 1 - To begin first power on the lights by pressing the light button
- 2 - Press the RGB button, a total of 7 colors can be selected, red, orange, yellow, green, cyan, blue, & purple. Long press the button to begin cycling through them.
- 3 - to power off the light hold the "Light" button for 3 seconds.

## 9. Bench LEDs - RGB Interior lighting system

Cal Sauna indoor saunas are designed with an additional beautiful LED lighting system. The system comes with its own independent controller to activate, configure, and select the RGB color of choice.

Note: the main control panel does NOT control this independent lighting system.

Since the lighting system is independent from the main sauna panel, you may operate the lights without activating the sauna.

## 9. Trouble Codes

Sensor Codes: The sauna uses a resistance based temperature probe to monitor the internal temperature of the sauna, if this temperature probe is damaged in any way you will see on the display "---" when operating the sauna. This means that no data is coming from the sensor. This can be due to a loose connection or a damaged sensor. Contact your Cal Sauna dealer for replacement parts or service.



## Tips For Use

- 1 - The sauna has an interior vent to help regulate interior temperature, you can open or close this vent based on your needs.
- 2 - Hydrate yourself before, during, and after sauna use with water. If you are using the sauna for recovery post workout, ensure that you consume an electrolyte beverage as well if you intend to use the sauna. Heat can accelerate the loss of electrolytes through excessive sweating, most notable after an workout. It is advised to take a small break before entering the sauna and during sauna use if necessary.
- 3 - Use a folded towel as a cushion to sit inside of the sauna, this also helps absorb sweat to keep your sauna clean.
- 4 - Take a lukewarm rinse before using the sauna to help promote sweating.

## Additional Sauna Safety Information

- 1 - Do not install this sauna near a body or open source of water, or in a humid/damp area.
- 2 - Do not use liquid detergents/cleaners inside the sauna. Use only water and a towel to wipe down the inside of sauna. Unplug the sauna before cleaning.
- 3 - Secure the saunas power cord away from any path or walking areas to avoid a trip hazard.
- 4 - Use only authorized Cal Sauna replacement parts, as these parts are designed to run at the specific voltage and amperage of the unit. Using 3rd party components may damage the power supply or cause damage, which would not covered under warranty.
- 5 - DO NOT USE EXTENSION CORDS OR SURGE PROTECTORS FOR THIS SAUNA.  
Only use a dedicated circuit for your sauna of 25 Amp
- 6 - Do not consume open beverages inside of the sauna, to avoid spilling liquids on the carbon IR heaters.
- 7 - Avoid excessive use of the sauna. Using the sauna Repeatedly or for extended periods of time may lead to dehydration, muscle spasms, and increase your odds of sustaining a heat stroke.
- 8 - Avoid wearing jewelry or dense metal piercings, as metals heat up much faster than your body and the saunas surroundings. The use of silicone piercings/jewelery are permitted and designed for use in swimming and other sports/activities.

### Resetting the Control Box Fuse

The sauna has an internal fuse that can be reset on the outside of the control box, If a situation occurs where the unit were to trip due to a power surge or a short circuit, remove the top lid of the sauna to access the power control box. Press the button once to reset.

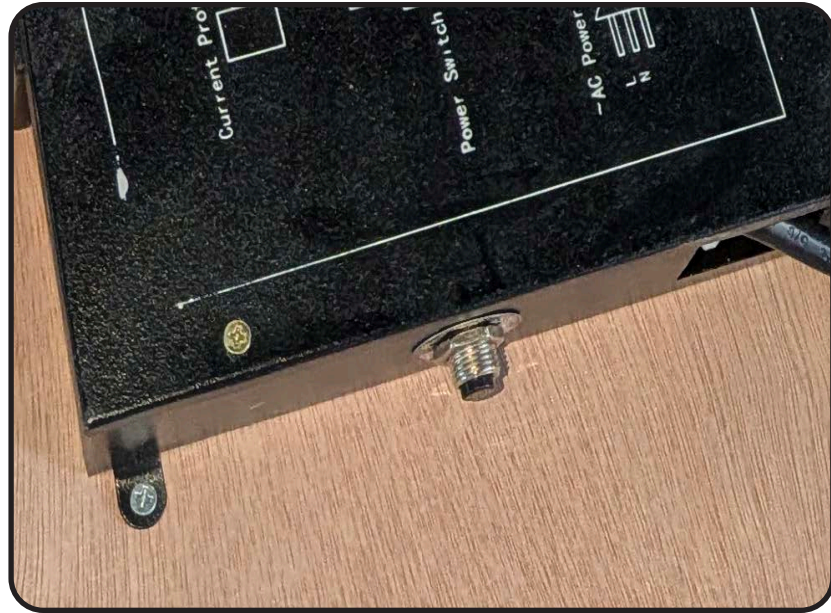

This fuse is designed to safely reset the saunas electrical circuit. If this fuse blows/resets repeatedly, contact your Cal Sauna dealer. Always reinstall the cover panel of the sauna after performing the control box fuse reset.

This Page is Intentionally Blank

# LIMITED WARRANTY

This Limited Warranty is extended to the original purchaser of the sauna distributed by Lloyd's Material Supply Company, Inc. Which distributes Cal Sauna branded saunas after January 1st 2026 and assembled/installed for indoor residential use in the Unites States of America and Canada. This warranty begins on the date of delivery of the sauna, and no later than 90 days after delivery. This warranty is void if the sauna is placed, installed, or operated outdoors, or/and used for commercial purposes.

## Structural

Warrantied against defects in materials affecting the balance/locking of wall panels. 1 Year

## Electrical

Warrantied against failure of Power Unit or Control panel due to defects in materials. 1 Year

## Carbon/IR Heater

Electrical equipment components - Specifically limited to the IR carbon heaters and circuit board, are warrantied against malfunction due to defects in materials. 1 Year

## Warranties on Other Components

Fuses, cables, and the internal LED lighting system are warrantied against defects in materials at time of delivery. Accessories offered with Cal Saunas, cup holders, towel racks, magazine racks, and door handles are warrantied for one year from day of arrival. Saunas equipped with an audio system carry a one year warranty against defects in materials from the date of arrival in regards to the speaker and amplifier. All other components not mentioned in this warranty are not covered under the saunas Limited Warranty.

## Genuine Cal Sauna Components

This Limited Warranty is voided if Lloyd's Material Supply Company .Inc or a designated representative determines that the sauna was subjected to damage of encountered an operational failure due to installation of aftermarket or 3rd party components that are not genuine Cal Sauna authorized parts and accessories. This disclaimer includes but is not limited to, IR heaters, carbon heaters, LED lights, power unit, power cords, replacement parts and accessories. Genuine Cal Sauna components are designed to operate with your Cal Sauna to ensure proper performance of the sauna.

## Performance

This warranty begins on the date of delivery of the sauna, but in no later event than 90 days from the date of arrival. To obtain service in the event of a malfunction or defect covered by this limited warranty, notify your Cal Sauna dealer or Cal Sauna as soon as possible, use all reasonable means to protect the sauna from further damage. Upon providing proof of purchase to your dealer, a designated service representative will authorize the order of new components, to repair the defective components in accordance to the terms and conditions contained in this warranty. There will be no charge for the cost of parts to repair the defect. Freight charges, labor fees, diagnose and travel fees are not covered by this limited warranty. Never store the sauna outdoors in its packaging, take proper steps to ensure it is stored away from the sunlight and elements if the sauna has to be stored for a short period of time.

In the event the sauna is removed from the property to a repair facility and reinstalled, the cost of removal and re-installation will be the responsibility as the sauna owner. If Lloyd's Material Supply Company .Inc, the distributor of Cal Sauna determines that the repair of the defect is not feasible, it reserves the right to provide a replacement sauna of equal or lesser value to the original purchase price. In such an event reasonable costs for removal of the original sauna, shipping costs to transport the defective unit or replacement unit, will the responsibility of the sauna owner. The replacement sauna will carry the balance of the original saunas warranty. This warranty ends by either the specified time frame, ownership transfer, relocation, or installation of other components not authorized by Cal Sauna.

### Warranties on Other Components

This Limited Warranty is void if Cal Sauna or its designated representative determines that the sauna has been subjected to alteration, neglect, misuse, or abuse, exposure to the outdoors, exposure to water or excess moisture, freight damage caused by the common carrier; any repairs attempted by anyone other than a designated representative or general technician. This warranty is void due to failure caused by accident, acts of God or other causes beyond the control of Cal Sauna including acts of nature (damage caused by animals, rodents, or other pests) are not covered by this warranty, additionally; neglect, misuse and abuse include any installation, operation or maintenance of the sauna other than in accordance with the instructions contained in the owner's manual. The use of improper cleaners or non-genuine parts and accessories will void this Limited Warranty. This Limited Warranty does not provide coverage for any item attached to or installed on the spa after the date of manufacture.

### Disclaimers

Lloyd's Material Supply Company, Inc, the Cal Sauna brand and its representatives shall not be liable for any injury, loss, cost, or other damage whether incidental or consequential, arising out of any defect covered by this limited warranty, including without limitation, loss of use of the sauna and cost for removal of defective produce even if Cal Sauna was advised of the possibility of damage. The liability of the manufacture and distributor under this limited warranty, if any shall not exceed the original amount paid for the defective product. Coverage under this limited warranty shall commence as of the original date of delivery and the duration of such coverage shall not extend for any reason whatsoever beyond the stated time period. These disclaimers shall be equally applicable to any service provided by the manufacture or distributor and its designated representatives.

This warranty is voided if the sauna is used, advertised, or showcased to be a feature for commercial applications. Commercial Use/applications of a Cal Sauna is viewed as but not limited too; installation in any short term rental property, or installations in properties hosted on services such as Air BnB, Vrbo, Sonder, Plum Guide, etc. Commercial Use also includes models installed in Hotels, Inns, Cottages, Hostels, or any location where temporary residence/usage is offered to the public, in exchange for currency or in material goods. Installation in locations such as public or members only gymnasiums will also void the saunas warranty. Installation in a personal home gymnasium for a single family is permitted, when following the specifications and electrical requirements mentioned in this owners manual.

### Legal Rights

This limited warranty give you specific legal rights. You may also have other rights that vary from state to state. Some states do not allow limitations on how long an implied warranty lasts, so this limitation may not apply to you.

For your record, please complete the following information.	
Date of Purchase	
Date of delivery	
Model Number	
Serial number	
Dealer Information (Name & Phone)	

